

Instruction Sheet 产品说明书

PA-31846

Dec. 2018 / 2018 年 12 月

TA Thermal Expansion Valve

TA 热力膨胀阀

Structure and Dimension (结构外形和尺寸) Unit (单位): mm

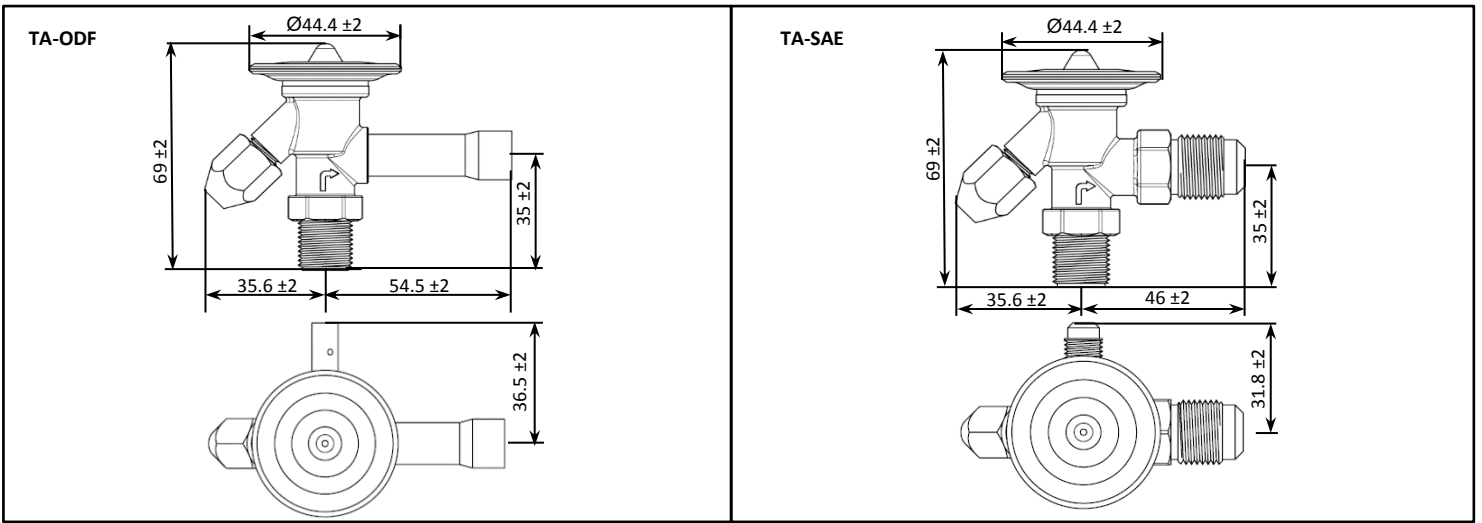

Charge Selection (充注选择)

Refrigerant	Operating Ranges (°F/°C)											
	-50°F -46°C	-40°F -40°C	-30°F -34°C	-20°F -29°C	-13°F -25°C	-10°F -23°C	0°F -18°C	10°F -12°C	20°F -7°C	30°F -1°C	40°F 4°C	50°F 10°C
R134a					MC							
					MW55							
R22			HCS									
			HW100									
R404A			SCS									
			SW75									

Mounting Method (安装方法)

1. System Pressures: Installation or Removal
(系统压力: 安装或拆除)

2. Warning
(警告)

3. Valve Orientation
(阀的安装角度)

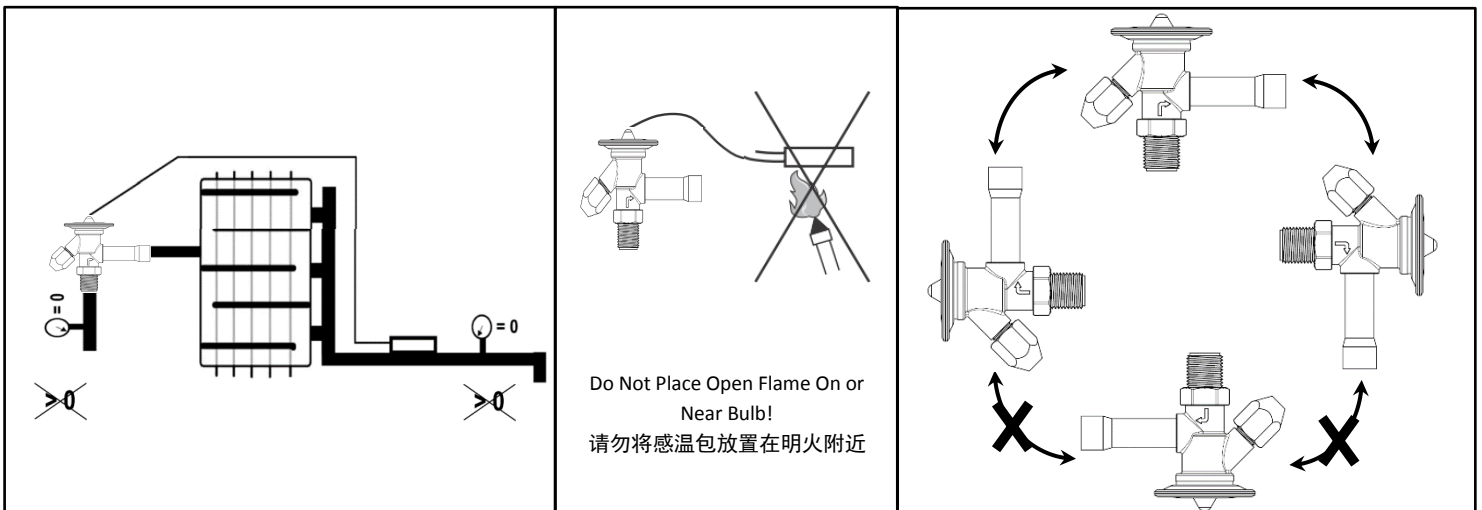

4. Pipe Dimension of Valve and Proper Torque for Fastening (阀的接管尺寸及拧紧所需力矩)

Pipe Dimension 接管尺寸			
Valve Type 阀体类型	Inlet 入口	Outlet 出口	Equalizer 平衡口
TA-ODF	5/8"-18UNF Flare	1/2"ODF	1/4"ODF
TA-SAE	5/8"-18UNF Flare	3/4"-16UNF Flare	7/16"-20UNF Flare

Proper torque for fastening the nuts 纳子紧固扭矩			
Thread 螺纹	5/8"-18UNF	3/4"-16UNF	7/16"-20UNF
Torque 扭矩	40~50N.M	50~60N.M	17~20N.M

5. Cage Mounting (阀芯安装)

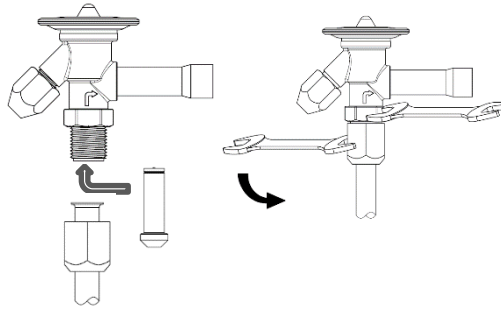

6. Welding (焊接)

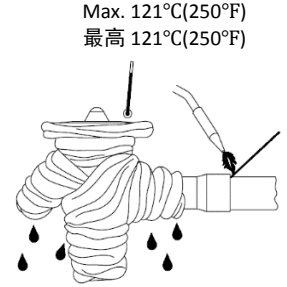

7. Bulb & External Equalizer Locations (感温包和外平衡管位置)

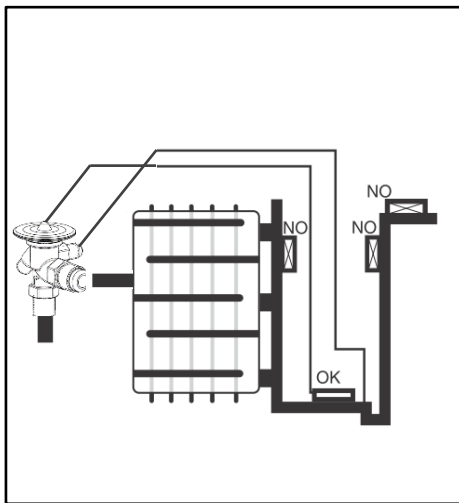

8. Bulb Location (感温包位置)

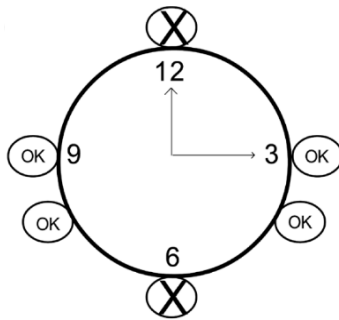

9. Determining Superheat (确定过热度)

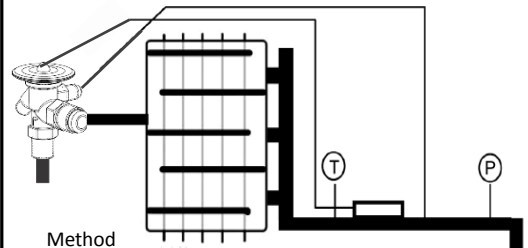

10. Static Superheat Changes(K) for One Full Turn of Adjusting Stem on 0°C (Evaporating Temp.) (蒸发温度 0°C 时调节杆调一圈静态过热度变化 K)

Refrigerant	K/Turn (Evap. Temp=0°C)
R22	2.3K
R404A	1.9K
R134a	3.4K

11. Adjust Superheat (调整过热度)

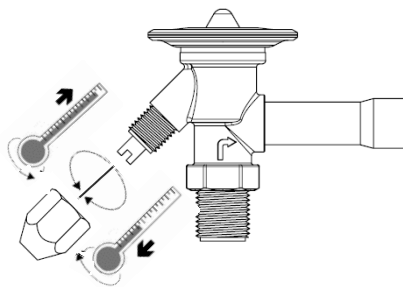

12. Maximum Working Pressure and Maximum Bulb Temperatures (最大工作压力及最大感温包温度)

TA MWP: 680psig /46.8bar g

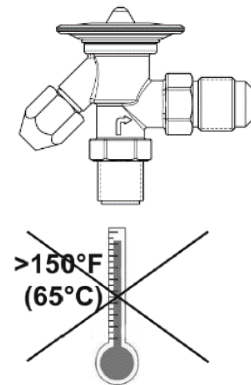

Technical data are correct at the time of printing. Updates may occur, and should you need confirmation of a specific value, please contact Emerson clearly stating the information required.

Emerson cannot be held responsible for errors in capacities, dimensions, etc., stated herein. Products, specifications and data in this literature are subject to change without notice.

The information given herein is based on data and tests which Emerson believes to be reliable and which are in accordance with today's technical knowledge. It is intended for use by persons having the appropriate technical knowledge and skill, at their own discretion and risk.

技术数据在印刷前已经校对过，印刷之后有再更新的可能，如有需要对某一参数确认，请联系艾默生环境优化技术。

艾默生环境优化技术对参数中可能存在的差错概不负责，艾默生环境优化技术保留自行改变其产品而不预先通知的权利。

本文件中的参数基于艾默生环境优化技术认为可靠的数据和测试，并符合今天的技术需求。这些信息预期由具有合适的专业知识和技能的人员自行判断和评估风险后来使用。